

3/8 MIP FITTING

STAINLESS STEEL  
REINFORCED

3/8" COMPRESSION NUT

COMPRESSION NUT  
& SLEEVE (NOT NEEDED)

9/16-24 UNEF THD

RUBBER BUSHING

CPVC

13/16-18 UNEF THD

1.15

WASHER PAPER THICKNESS (.015)

3 5/16 O.D.

Ø 3.26

Ø 4.41

3 3/4

2.450

1.975

ZINC NUT

POLY WASHER

ZINC NUT

1.725

12

1.950

RUBBER WASHER (.10 THICKNESS)

SHALLOW FLANGE 1 1/2 IPS  
WHITE PLASTIC

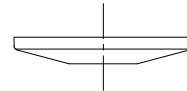

NOTES:

1. ALL DIMENSIONS ARE IN INCHES.
2. MATERIAL: LOW LEAD BRASS
3. FINISH: CHROME PLATE
4. INCLUDES: -3- VALVES & -3- FLANGES
5. VALVES COME W/ NUTS & COMPRESSION SLEEVES.

THE KEENEY MANUFACTURING COMPANY  
NEWINGTON, CT

TITLE: MASTERKIT - KITCHEN SINK P/N:MK-1004LF

DWG BY: RKH

DATE:8/07/14

SCALE:SHOWN